

# DA890 Power centres for AXIS A1001 controllers



DA890IN



DA890EX

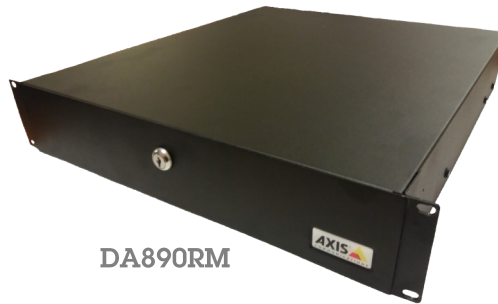

DA890RM



DA890INQUAD

 **Mains input**  
90 < 270V AC

Maximum total lock output  
12V 2A DC or 24V 1A DC

Or

 **PoE+ input**

Maximum total lock output  
12V 1A DC or 24V 500mA DC

# DA890 Indoor, Outdoor and Rack mount Power centre for AXIS A1001 - Application example

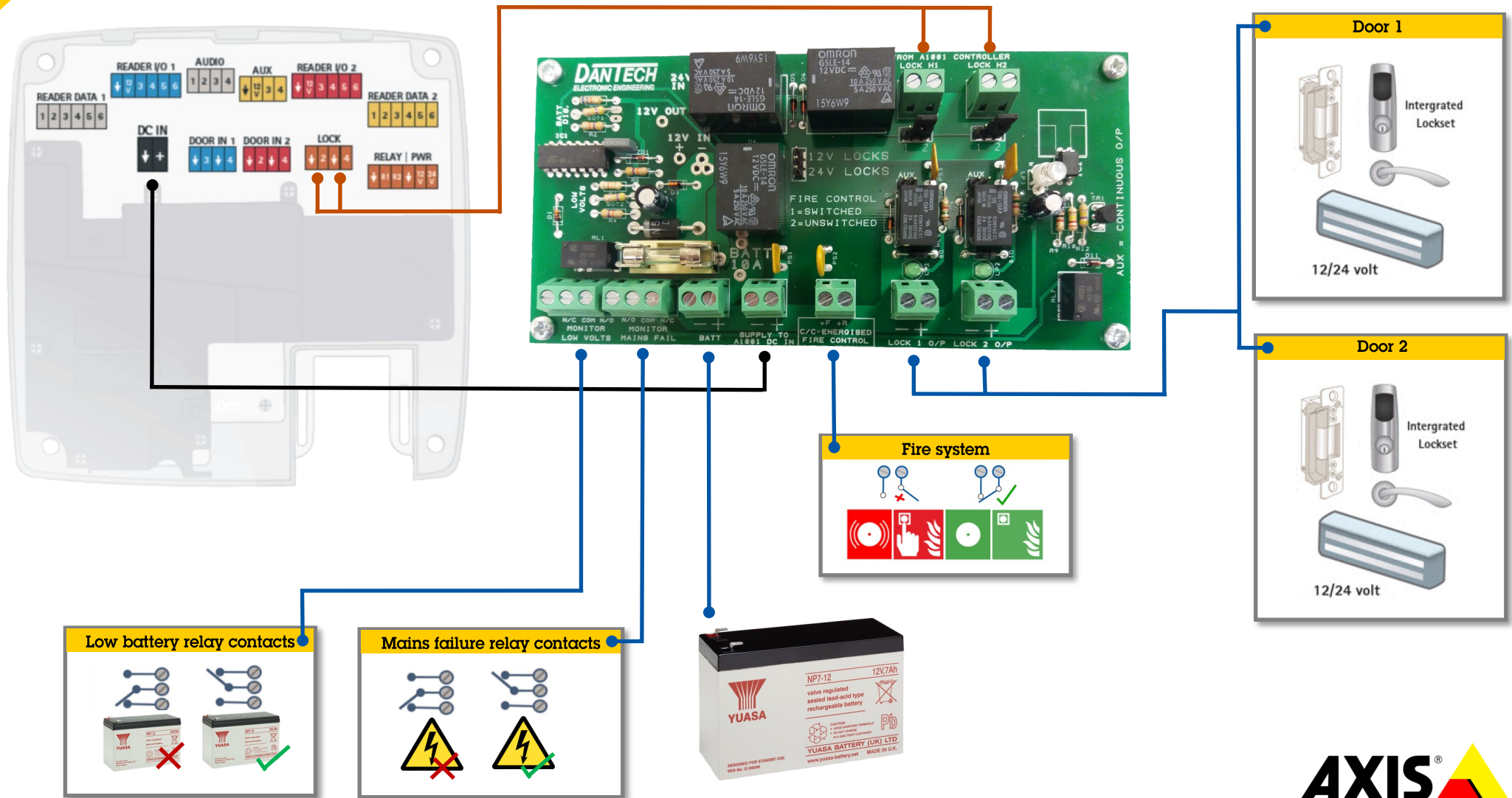

# DA890IN Power centre for AXIS A1001 - Wiring example

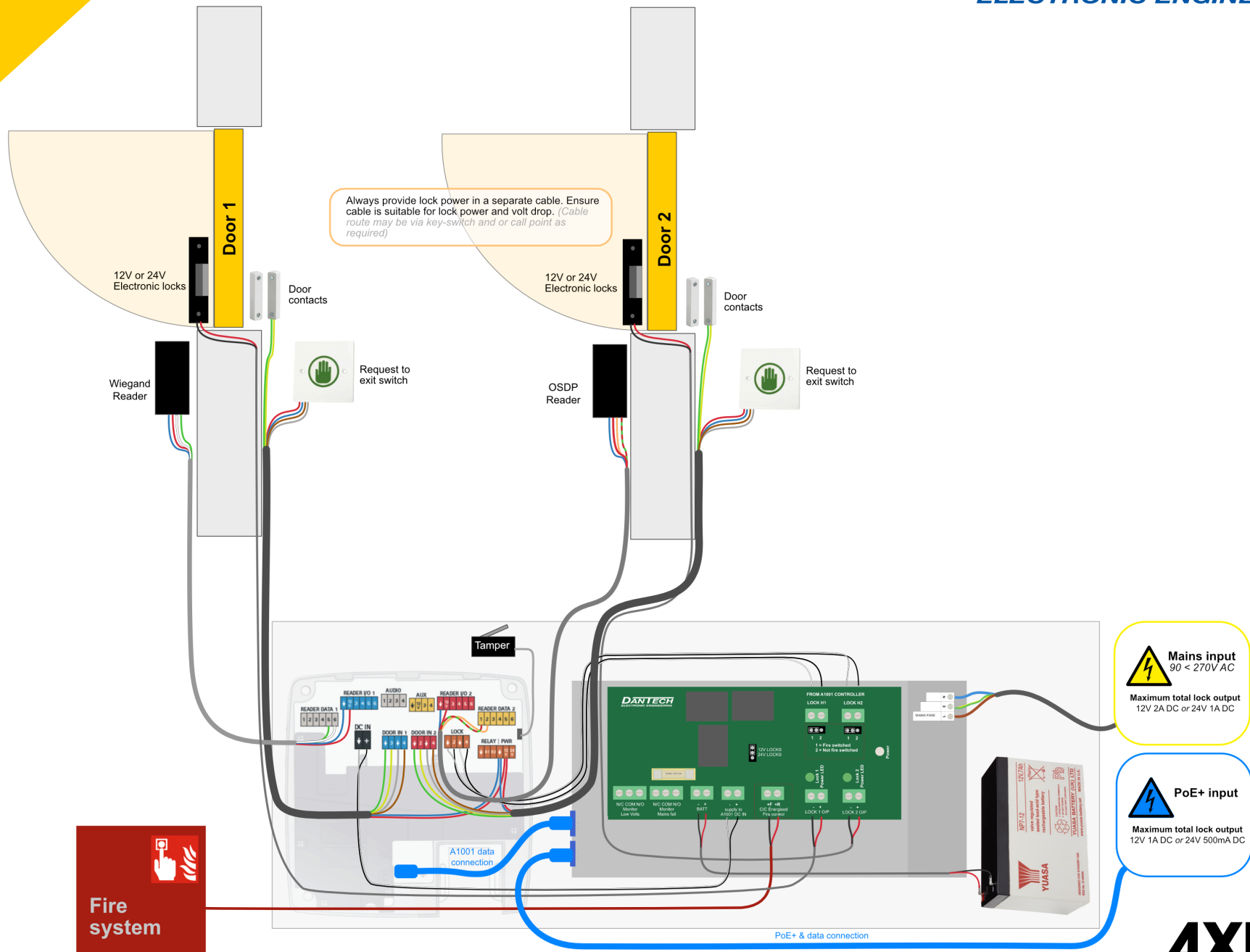

# DA890INQUAD Power centre for multiple AXIS A1001

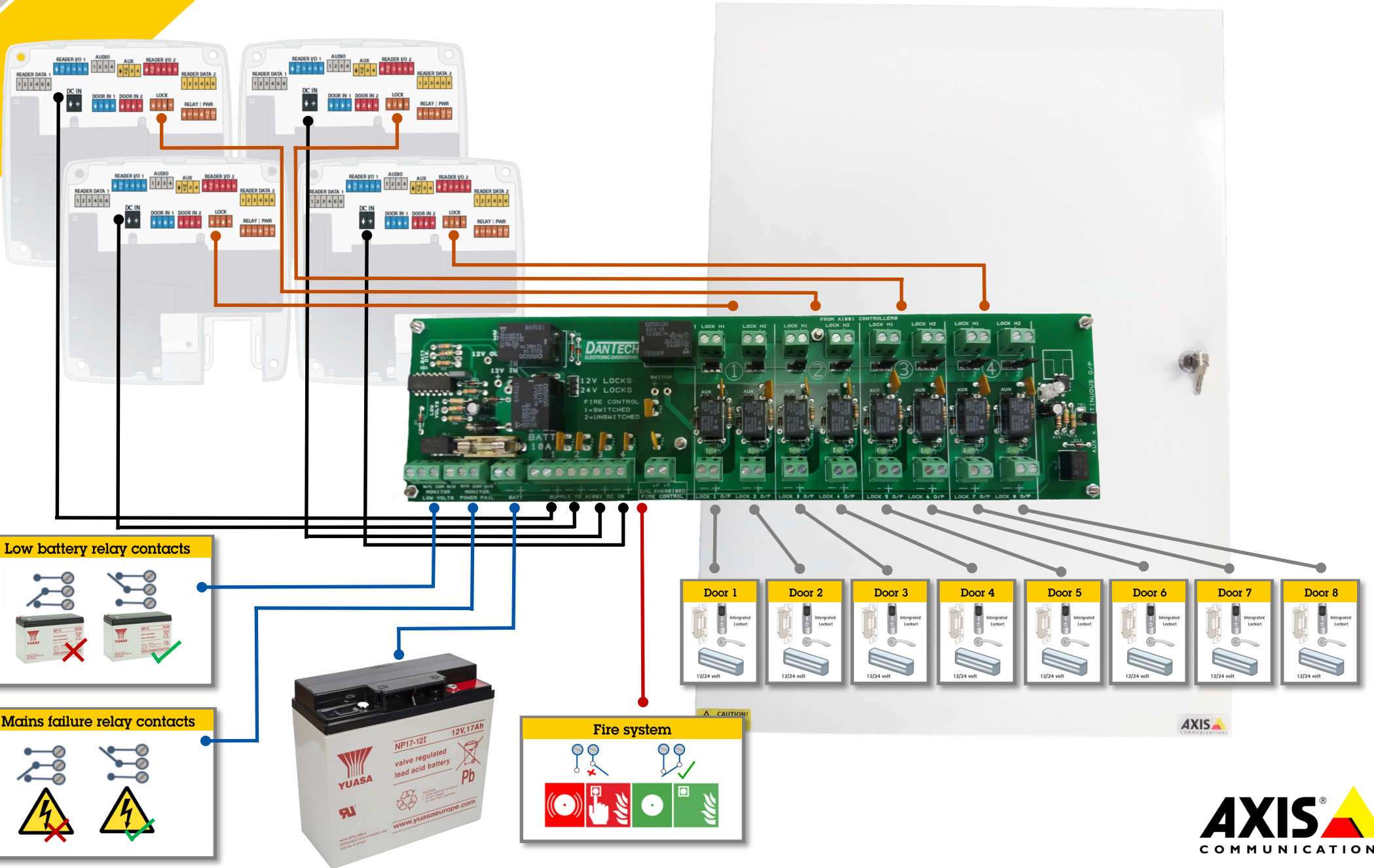

**Low battery relay contacts**

**Mains failure relay contacts**



**Fire system**

